

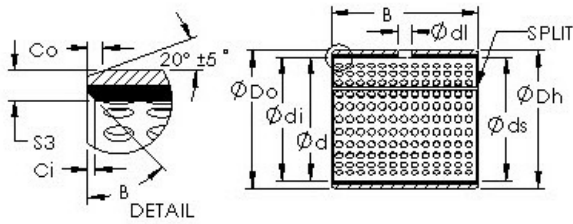

BEARING DRIVESHAFT, INC.

AST AST20 18060 plain bearings



Bearing No. AST20 18060

Bore Diameter	180 mm
Outer Diameter	185 mm
Bearing Type	straight
Shaft Dia., Nominal (d)	180.0000
Shaft Size (ds) - 180 +0 / -0.063	180 +0 / 0.063
Housing Bore Dia. (Dh) - 185 +0.046 / -0	185 +0.046 / 0
Bearing Outside Diameter, Nominal(Do)	185.000
Bearing Outside Diameter Tolerance (Do tol.)	185.210 / 185.130
Bearing Bore after Mounting (di)	180.276 / 180.110
Average Clearance (Cd)	0.2250
Wall Thickness (S3)	2.418
Bearing Length, Nominal (B)	60.000
Bearing Length Tolerance (B tol.) - +0 / -0.40	+0 / 0.40
OD Chamfer Length (Co)	1.800
ID Chamfer Angle (B deg.)	45
ID Chamfer Length (Ci)	0.800
Lube Hole Dia. (dl)	9.500
Material	Carbon steel shell with POM plastic liner

AST20 18060 Bearing 2D drawings and 3D CAD models