

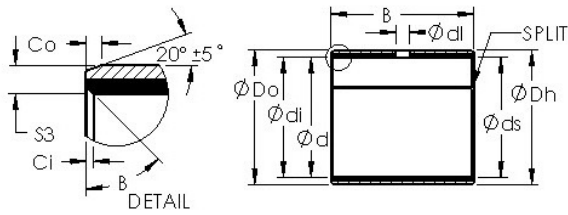

BEARING DRIVESHAFT, INC.



AST AST40 14060 plain bearings

Bearing No. AST40 14060

Bore Diameter	140 mm
Outer Diameter	145 mm
Bearing Type	straight
Shaft Dia., Nominal (d)	140.0000
Shaft Size (ds) - 140 -0 / -0.063	140 0 / 0.063
Housing Bore Dia. (Dh)	145 +0.040 / +0
Bearing Outside Diameter, Nominal (Do)	145.000
Bearing Outside Diameter Tolerance (Do tol.)	145.17 / 145.1
Bearing Bore after Mounting (di)	140.21 / 140.07
Average Clearance (Cd)	0.1720
Wall Thickness (S3)	2.465
Bearing Length, Nominal (B)	60.000
Bearing Length Tolerance (B tol.) - +0 / -0.40	+0 / 0.40
OD Chamfer Length (Co)	1.800
ID Chamfer Angle (B deg.)	45
ID Chamfer Length (Ci)	0.600
Material	Steel shell with PTFE / Polymer Fiber lining

AST40 14060 Bearing 2D drawings and 3D CAD models