

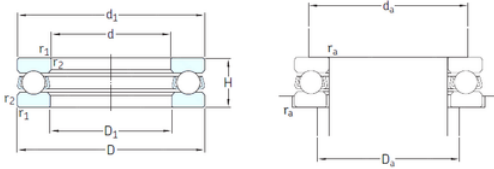

# BEARING DRIVESHAFT, INC.

## SKF 511/530F thrust ball bearings



Bearing No. 511/530F

Size	530x640x85 mm
Bore Diameter	530 mm
Outer Diameter	640 mm
Width	85 mm
d	530 mm
D	640 mm
H	85 mm
d1	636 mm
r1 min.	3 mm
r2 min.	3 mm
D1	534 mm
da min.	595 mm
Da max.	575 mm
ra max.	2,5 mm
Weight	58,5 Kg
Basic dynamic load rating (C)	650 kN
Basic static load rating (C0)	4 400 kN
Fatigue load limit (Pu)	68
Reference speed	530 r/min
Limiting speed	750 r/min

511/530F Bearing 2D drawings and 3D CAD models